



Exceptional  
Customer  
Service

Same Day  
Shipping

Easy  
Fastening  
Solutions

Repair & Service  
Tools / Rentals

Tools & Parts  
In Stock

## C6000 / C7000 INSTRUCTIONS

The C6000/C7000 is a hand-operated Rivnut header available for the following standard thread sizes:

RIVNUT - #4 through 1/4" (M3 through M6)  
PLUSNUT - #4 through #10 (M3 through M5)

### HOW TO OPERATE

With handle (A) all the way out, place Rivnut fastener on pull-up stud. Hold Rivnut fastener firmly to prevent turning while handle (A) is pushed all the way in. (Push—do not strike.) This spins the stud, engaging all threads in the Rivnut. Place Rivnut in hole, holding tool at right angle to face of work. Squeeze lever (B) until solid resistance is met. Lever will not need to go all the way down. Excessive pressure will strip the threads. Release lever (B) and pull handle (A) all the way out. This will unthread stud from Rivnut.

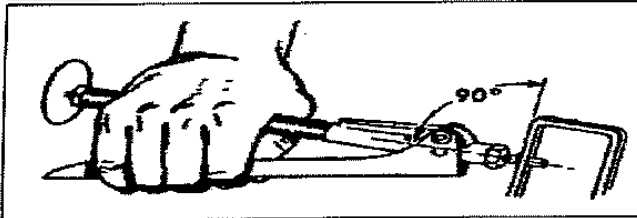
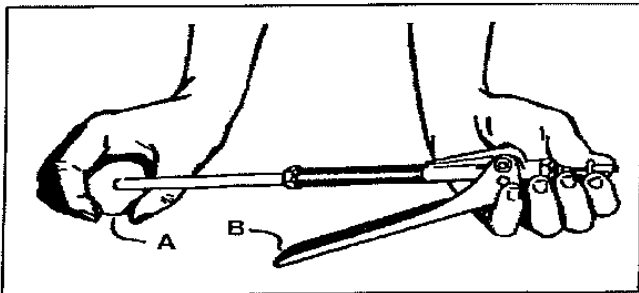

### HOW TO REPLACE BROKEN OR DAMAGED PULL-UP STUD

1. Unthread anvil sleeve from tool.
2. Loosen 3 set screws at access hole "A."
3. Loosen two set screws at access hole "B" and let key wrench remain in the second set screw to prevent rotation of coupling while stud is being unscrewed.

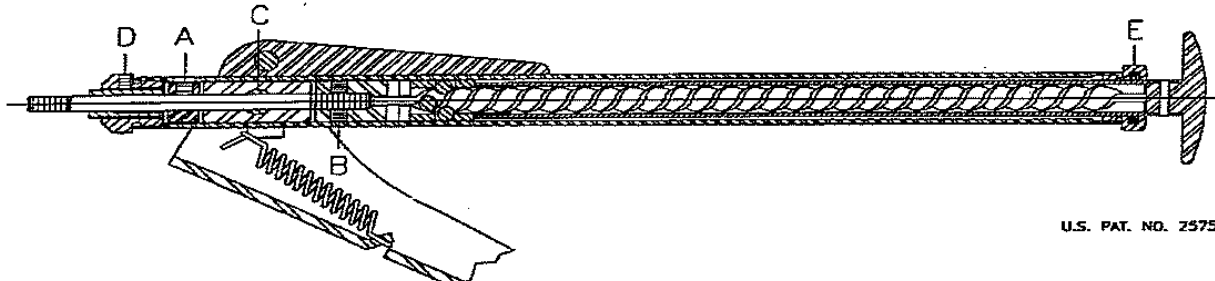

4. Secure pull-up stud in aluminum or copper jaws of vise and turn entire tool counter-clockwise, unscrewing stud from coupling.
5. Before installing replacement stud, line up hole through cross pin indicated at "C."
6. Slip collar loosely on replacement stud and insert stud through plunger, screwing stud into coupling until end of stud is just past the second set screw hole, then tighten both set screws at "B." (Longer threaded portion of stud goes into tool.)
7. Tighten 3 set screws in collar through access hole "A."
8. Replace anvil and sleeve and tighten set screw "D" after anvil is properly adjusted for Rivnut fastener length as shown on other side of page.

**NOTE:** Changing to pull-up stud of another thread size requires change of adjustable anvil, pull-up stud, collar and coupling. Follow above replacement procedure, except nut "E" must be loosened to remove operating screw and slide from tool handle to replace coupling. See drawing, other side of page.

**OILING:** An occasional drop or two of heavy oil (SAE-20-30) on the operating screw (Part No. 69-1008) and a drop of light oil on slide (Part No. 69-1006) at bushing (Part No. 50-5001) will keep tool operating smoothly. (See parts drawing, opposite side of sheet.)

### OPERATING RANGE

C-6000 (Rivnut)	#4 (M3)	#6 (M4)	#8 (M5)	#10 (M5)	1/4" (M6)	5/16" (M8)	3/8" (M10)
Aluminum	☑	☑	☑	☑			
Brass & Steel	☑	☑	☑	☑			
Stainless Steel	☑	☑	☑	☑			
C-7000 (Plusnut)	#4 (M3)	#6 (M4)	#8 (M5)	#10 (M5)	1/4" (M6)	5/16" (M8)	3/8" (M10)
Aluminum	☑	☑	☑	☑			
Brass & Steel	☑	☑	☑	☑			
Stainless Steel	☑	☑	☑	☑			

☑ Recommended    ☐ Adequate but borderline strength recommend power tool

U.S. PAT. NO. 2575479

ISO 9001:2008 CERTIFIED

www.cardinalcomponents.com • info@cardinalcomponents.com  
W128 N8600 Old Orchard Rd., Menomonee Falls, WI 53051  
Visa, Mastercard, Discover & Am Ex Accepted • Fax: 262.252.5033

CALL TODAY  
800.236.3200



Exceptional  
Customer  
Service

Same Day  
Shipping

Easy  
Fastening  
Solutions

Repair & Service  
Tools / Rentals

Tools & Parts  
In Stock

## C6000 / C7000 INSTRUCTIONS & PARTS LIST

### ADJUSTING ANVIL TO SUIT FASTENER LENGTH

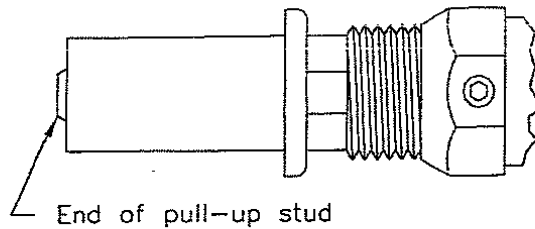

Threads may be deformed or stripped if the pull-up stud does not engage all threads in the fastener. Speed Headers and all power tools have pull-up studs or anvils which can be adjusted easily to suit the part length. The sketch demonstrates proper relation between face of anvil and end of pull-up stud. The point of the pull-up stud should extend just beyond the end of the fastener.

### PARTS FOR C6000/C7000 SPEED HEADER

When ordering a tool or part, always specify thread size.

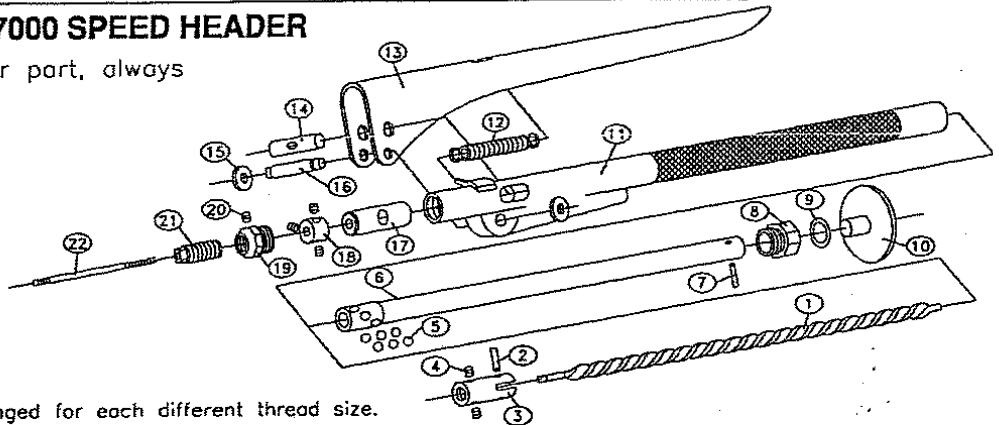

(\*) These parts must be changed for each different thread size.

ITEM	DESCRIPTION	PART NO. (C6000)	PART NO. (C7000)	QUANTITY
1	Operating Screw	69-1008	69-1008	1
2	Pin	52-4124	52-4124	1
3	* Coupling	60-2400-1 (#4, #6) 60-2400-2 (#8, M3, M4) 60-2400-3 (#10-#25, M5-M6)	60-2400-1 (#4, #6) 60-2400-2 (#8, M3, M4) 60-2400-3 (#10-#25, M5-M6)	1
4	Set Screw	53-3005	53-3005	5
5	3/16" Steel Balls	54-2000	54-2000	6
6	Slide Nut Assembly	70-3005	70-3005	1
7	Knob Pin	52-4094	52-4094	1
8	Slide Bushing	50-5001	50-5001	1
9	O-Ring	51-2110	51-2110	1
10	Knob	68-5000	68-5000	1
11	Handle Assembly	70-3004	70-3006	1
12	Spring	54-1008	54-1008	1
13	Squeeze Handle	68-3000-1	68-3001	1
14	Cross Pin	52-1308	52-1308	1
15	Washer (for Hinge Pin)	55-1218	55-1218	2
16	Hinge Pin	52-1250	52-1250	1
17	Plunger	69-1005	69-1005	1
18	* Collar	69-1007-1 (#4) 69-1007-2 (#6) 69-1007-3 (#8) 69-1007-4 (#10-#25, M5-M6) 69-1007-5 (M3) 69-1007-6 (M4)	69-1007-1 (#4) 69-1007-2 (#6) 69-1007-3 (#8) 69-1007-4 (#10-#25, M5-M6) 69-1007-5 (M3) 69-1007-6 (M4)	1
19	Adjustable Anvil Sleeve	62-3008	62-3008	1
20	Set Screw	53-3008	53-3008	1
21	* Adjustable Anvil	60-3400-XXX (#4-#10, M3-M4) 60-3401-XXX (#12-#25, M5-M6)	60-3400-XXX (#4-#10, M3-M4) 60-3401-XXX (#12-#25, M5-M6)	1
22	* Pull-up Stud	60-1400-XXX (#4-#8, M3-M4) 60-1401-XXX (#10-#25, M5-M6)	60-1400-XXX (#4-#8, M3-M4) 60-1401-XXX (#10-#25, M5-M6)	1

ISO 9001:2008 CERTIFIED

CALL TODAY  
800.236.3200

www.cardinalcomponents.com • info@cardinalcomponents.com  
W128 N8600 Old Orchard Rd., Menomonee Falls, WI 53051  
Visa, Mastercard, Discover & Am Ex Accepted • Fax: 262.252.5033